

# TETRA 180 RATINGS AND SPECIFICATIONS

		<b>T180 22,5 17</b>	<b>T180 35 17</b>	<b>T180 47 17</b>
L (Without Brake)	mm	290	350	410
L (With Brake)	mm	350	410	470
A	mm	60	80	80
d	mm	28 (j6)	38 (k6)	38 (k6)
ch	mm	8x7x50	10x8x70	10x8x70
F	mm	M10x22	M12x28	M12x28

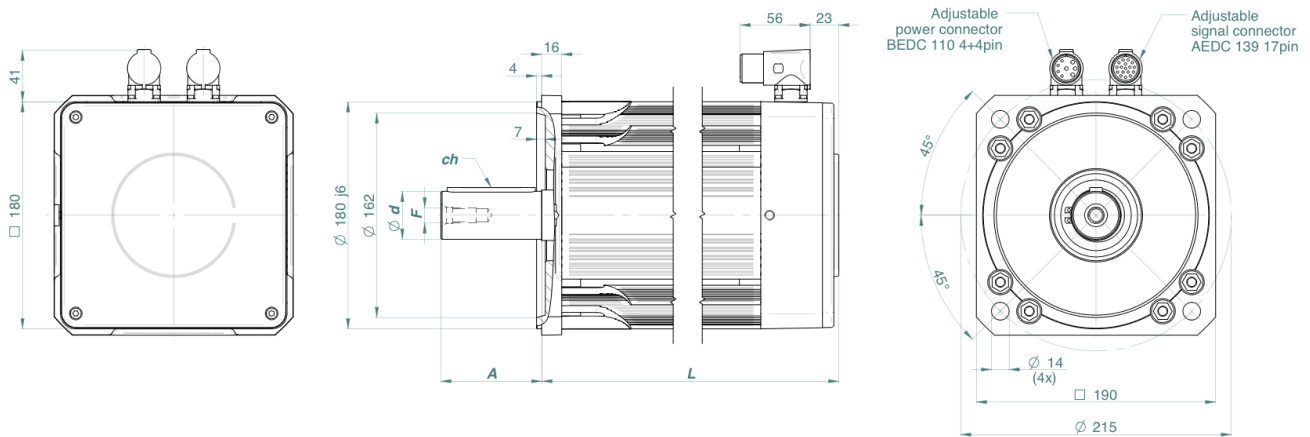

Power connector 4+4 PIN M23 turnable BEDC 110 - Signal connector 17 PIN M23 turnable AEDC 139

Dimensions in mm