

| | |
|--|----------------|
| Rated Voltage (Vac) | 220 |
| Rated Power (w) | 1500 |
| Rated Torque (N.m) | 4.9 |
| Peak Torque (N.m) | 12.5 |
| Rated Speed (rpm) | 3000 |
| Peak Speed (rpm) | 5000 |
| Rated Current (Amp) | 6.8 |
| Peak Current (Amp) | 17.1 |
| Torque Const (N.m/Amp) | 0.72 |
| Inertia (kg*m ² *10 ⁻⁴) | 14.8 |
| Poles | 10 |
| Encoder type | 23bit magnetic |
| IP rating | IP65 |
| Mass (Kg) | 7.0 |

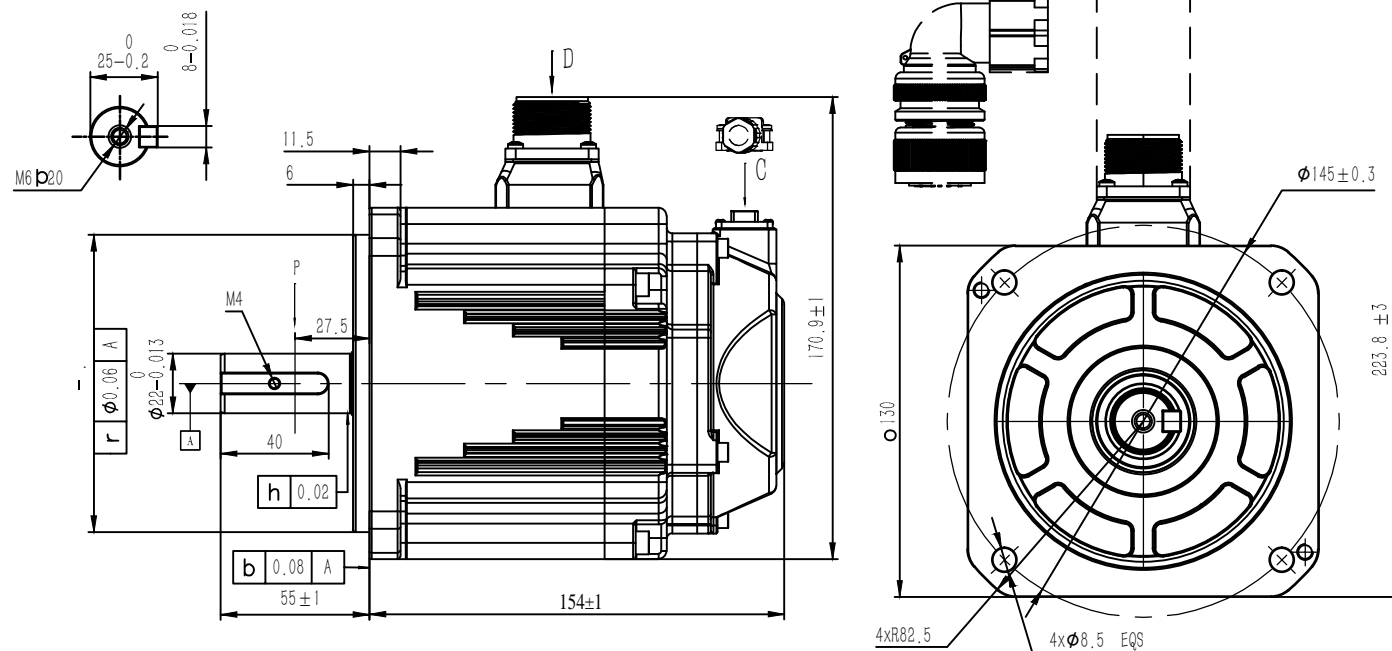

| | |
|-----------------------------|---|
| Power Cable (with brake) | CABLE-RZSH***-135-TS |
| Encoder Cable | CABLE-BMH***-114-TS (For Inc) CABLE-BMAH***-124-TS (For Abs) |

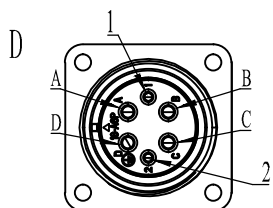
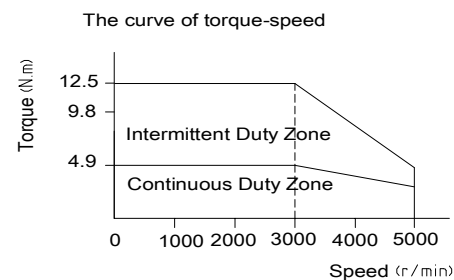

| Assignment of power connector with brake | | | | | | |
|--|---|---|---|----|---|-----|
| Pos | A | B | C | D | 1 | 2 |
| Signal | U | V | W | PE | 0 | 24V |

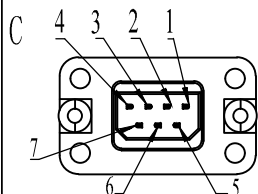

| Assignment of encoder connector | | | | | | | |
|---------------------------------|----|----|----|-----|-----|------|------|
| Pos | 1 | 2 | 3 | 4 | 5 | 6 | 7 |
| Signal | PE | 5V | 0V | SD+ | SD- | BAT+ | BAT- |

Leadshine Technology Co .Ltd

ELM1M-1500MA130E-H

130mm, medium inertia, 1500w, brake
23bit multi-turns magnetic encoder