

DUET FLEXI 80 TORQUE /SPEED CHARTS

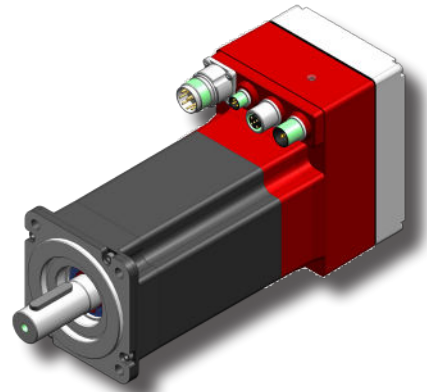

DUET FLEXI 80 1,5 03

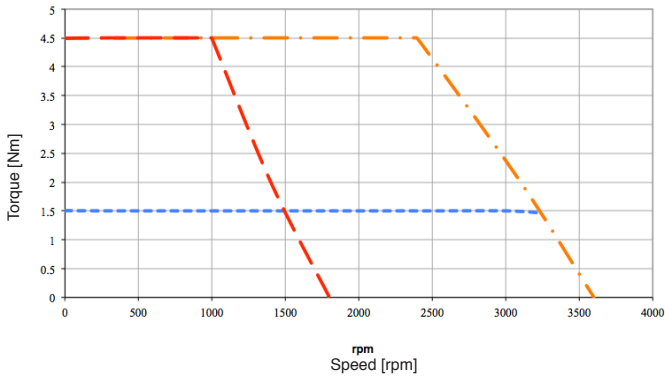

Continuous duty (S1) operation with cooling system appropriately sized.

DUET FLEXI 80 2 03

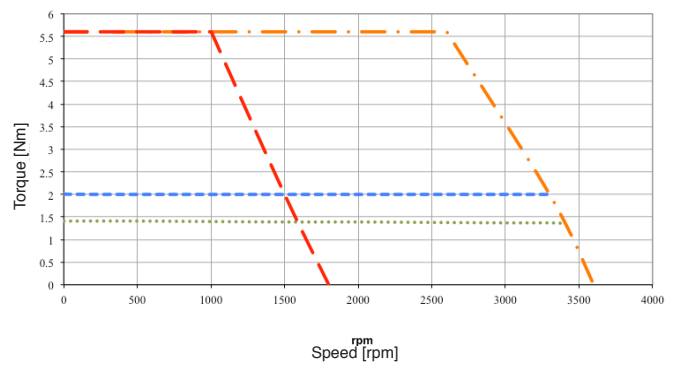

Continuous duty (S1) operation with cooling system appropriately sized.

- Continuous duty @ rated voltage
- - - 24 Vdc
- . - . 48 Vdc
- - - Continuous duty @ T(power stage) ≤50°C
- • • • • Continuous duty @ T(power stage) ≤70°C