

INDUCTION MOTORS

60W □90mm

LEAD WIRE TYPE

DIMENSIONS

K9IP60F□

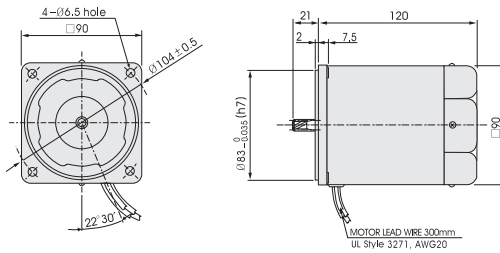

K9IS60F□

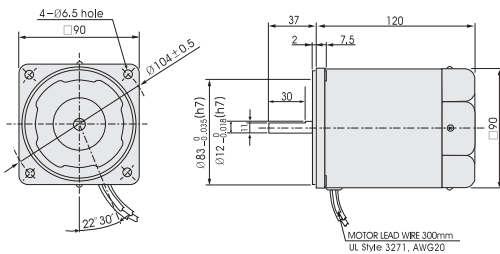

CONNECTION DIAGRAMS

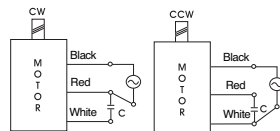

SPECIFICATIONS

continuous rating, four poles class E or A

The direction of motor rotation is as viewed from the front shaft end of the motor

Model	Output (W)	Voltage (V)	Frequency (Hz)	Current (A)	Starting Torque (mN·m) (gfcM)	Rated Torque (mN·m) (gfcM)	Speed (rpm)	Condenser (μF)	
K9IP60FU K9IS60FU	single-phase	60	110	1.30	350	400	1550	16	
			115		350	4000			
K9IP60FC K9IS60FC	single-phase	60	220	0.60	350	400	1550	4	
			60		350	4000			
			230	50	0.62	390	470		1250
				60	0.72	390	4700		1550
K9IP60FH K9IS60FH	single-phase	60	220	0.48	1450	370	1600	-	
					1450	3700			
			230	50	0.63	1150	460		1350
					1150	4600			
				60	0.49	1450	370		1600
						1450	3700		

GEARHEADS

DIMENSIONS

DECIMAL GEARHEAD

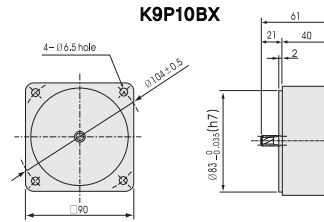

GEARHEAD

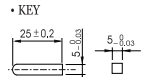
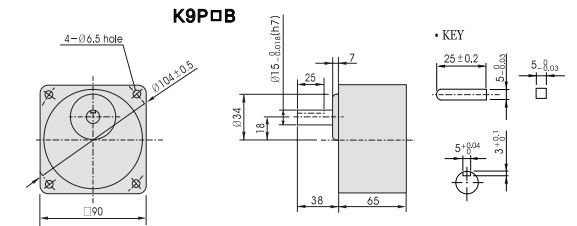

DIMENSION TABLE

PART No.	L	APPLICATION MODEL	MOUNTING BOLT
01	65	K9P3~180B	M6 P1.0×95
02	65	K9P3~180BF	M6 P1.0×25
03	40	K9P10BX	M6 P1.0×140

K9P□BF

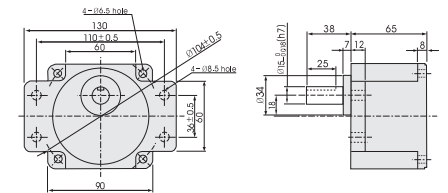

K9IP60F□ + K9P□B

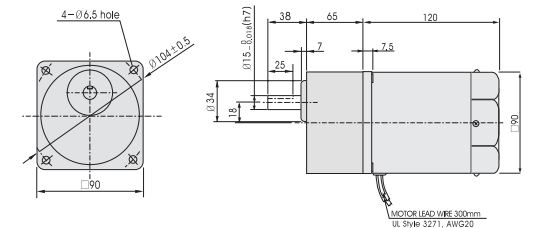

RATED TORQUE OF GEARHEAD

● 50Hz

Model Motor/ Gearhead	Speed(rpm)		Ratio																		
	500	416	300	250	200	166	120	100	83	60	50	41	30	25	20	16	15	12.5	10	8.3	
K9IP60F□	1.14	1.37	1.90	2.28	2.86	3.43	4.28	5.14	6.17	7.71	9.25	11.10	15.42	18.50	20	20	20	20	20	20	20
K9P□B, K9P□BF	11.4	13.7	19.0	22.8	28.6	34.3	42.8	51.4	61.7	77.1	92.5	111.0	154.2	185.0	200	200	200	200	200	200	200
K9IP60FH	1.12	1.34	1.86	2.24	2.79	3.35	4.19	5.03	6.04	7.55	9.05	10.87	15.09	18.11	20	20	20	20	20	20	20
K9P□B, K9P□BF	11.2	13.4	18.6	22.4	27.9	33.5	41.9	50.3	60.4	75.5	90.5	108.7	150.9	181.1	200	200	200	200	200	200	200

unit=above : N · m / below : kgfcm

● 60Hz

Model Motor/ Gearhead	Speed(rpm)		Ratio																		
	600	500	360	300	240	200	144	120	100	72	60	50	36	30	24	20	18	15	12	10	
K9IP60F□	0.97	1.17	1.62	1.94	2.43	2.92	3.65	4.37	5.25	6.56	7.87	9.45	13.12	15.75	17.71	20	20	20	20	20	20
K9P□B, K9P□BF	9.7	11.7	16.2	19.4	24.3	29.2	36.5	43.7	52.5	65.6	78.7	94.5	131.2	157.5	177.1	200	200	200	200	200	200
K9IP60FH	0.90	1.08	1.50	1.80	2.25	2.70	3.37	4.05	4.86	6.07	7.28	8.74	12.14	14.57	16.39	19.66	20	20	20	20	20
K9P□B, K9P□BF	9.0	10.8	15.0	18.0	22.5	27.0	33.7	40.5	48.6	60.7	72.8	87.4	121.4	145.7	163.9	196.6	200	200	200	200	200

unit=above : N · m / below : kgfcm

* Gearhead and decimal gearhead are sold separately.

* The code in □ of gearhead model is for gear ratio.

* color indicates that the output shaft of the geared motor rotates in the same direction as the output shaft of the motor. Others indicate rotation in the opposite direction.

* If you are to have less ratio than the ratio in the table, you can install the decimal gearhead, which has one tenth of the ratio, between the gearhead and the motor. In this case, the permissible torque is 20N · m/200kgfcm.