

REVISION			
REV.	DATE	DESCRIPTION	DRAWN BY
01	2013/10/08	Wire color changed	

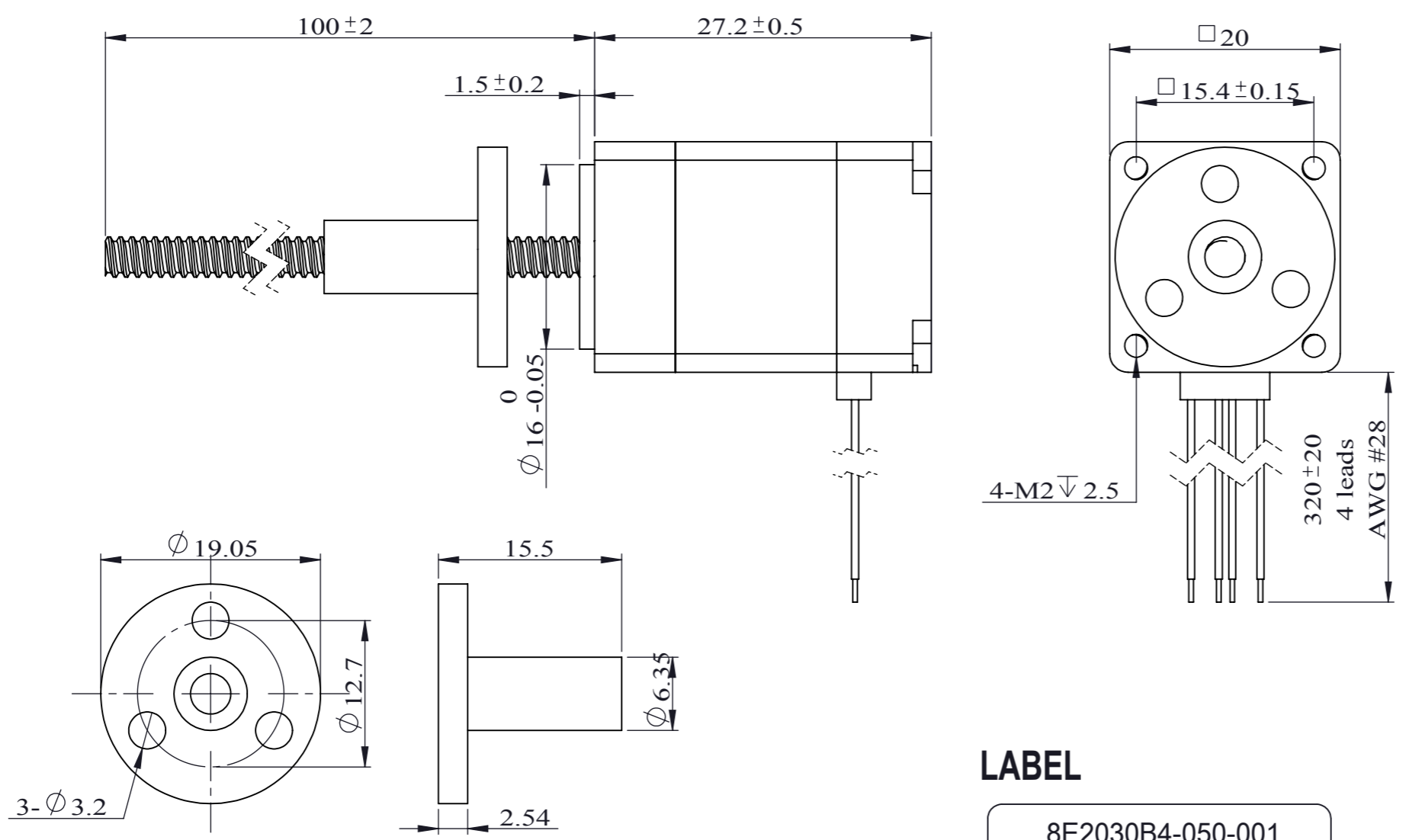

LABEL

8E2030B4-050-001
DINGS' MOTION
work order
DATE REV01

TECHNICAL PARAMETERS

Motor's phase 电机相数	2
Step angle 步距角	1.8°
Rated voltage 额定电压	2.55 V
Rated curren/phase 额定相电流	0.5 A
Resistance/phase 相电阻	$5.1\Omega \pm 10\%$
Inductance/phase 相电感	$1.5mH \pm 20\%$
Linear travel per step 步长	0.006096mm/step
Lead diameter 螺杆外径	$\phi 3.5mm$
Lead screw lead 螺杆导程	1.2192mm
Insulation calss 绝缘等级	B
Insuration resistance 绝缘电阻	$100M\Omega(500VDC)$
Heat rise 温升	$80^\circ C$
Motor weight 电机重量	0.08 kg

LEAD WIRE CONFIGURATION

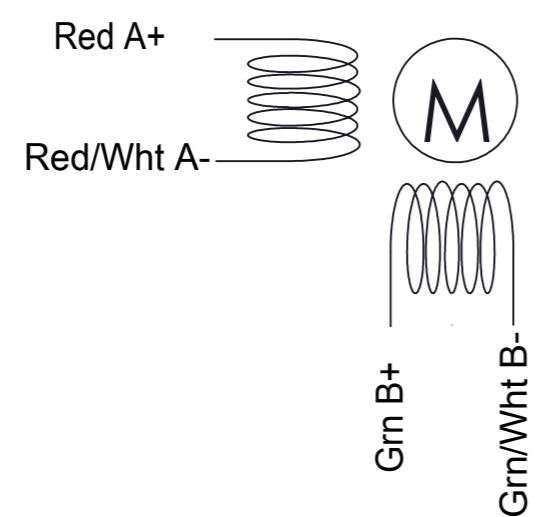

Winding excited sequence 电机通电运转				
CCW 反转	→			
A+	+		-	
A-	-		+	
B+		-		+
B-		+		-
CW 正转	←			

客户 Customer		技术规格书 Specification	
KOCO MOTION		视图 <input type="checkbox"/> 重要尺寸 <input checked="" type="checkbox"/>	
UNLESS OTHERWISE SPECIFIED: DIMENSIONS ARE IN MILLIMETERS 尺寸单位为毫米 (mm). TOLERANCES AS BELOW: 未注公差按以下标准:			
ANGLE $\pm 1^\circ$	角度 $\pm 1^\circ$	Name 姓名	DATE 日期
英寸 inch	毫米 mm	何超	2010.07.06
.X ± 0.04	X. ± 1	DRAWN 设计	
.XX ± 0.01	.X ± 0.25	MFG'D 工艺	
.XXX ± 0.005	.XX ± 0.13	Checkd 审核	
.XXXX ± 0.0005	.XXX ± 0.013	QA 质量	
		APPVD 批准	

常州市鼎智机电有限公司 DINGS' MOTION	
TITLE: Linear Actuator 线性步进电机	
DWG NO. 8E2030B4-050-001	A3
SCALE:	SHEET 1 OF 1