

Size 34 (86mm) Series

The size 34 hybrid precision linear actuator is our biggest in size, and can provide up to 2270N of continuous thrust



Motor Characteristics

Motor	Voltage (V)	Current (A)	Resistance (Ω)	Inductance (mH)	Weight (g)	Lead Wire No.	Motor Length (mm)
34-2113	12.0	1.3	9.2	71.0	2370	4	76
34-2130	5.7	3.0	1.9	15.0	2370	4	76
34-2155	2.85	5.5	0.52	4.5	2370	4	76

Available Lead Screw and Travel per Step

Screw Dia. (inch)	Screw Dia. (mm)	Lead (inch)	Lead (mm)	Lead Code	Travel Per Step @ 1.8 deg (mm)*	Travel Per Step @ 0.9 deg (mm)*
0.625	15.875	0.1	2.54	K	0.0127	0.0064
0.625	15.875	0.125	3.175	L	0.0159	0.0079
0.625	15.875	0.2	5.08	R	0.0254	0.0127
0.625	15.875	0.25	6.35	S	0.0318	0.0159
0.625	15.875	0.5	12.7	Y	0.0635	0.0318
0.625	15.875	1.0	25.4	Z	0.127	0.0635

*Value truncated

Dimensional Drawings External Actuator

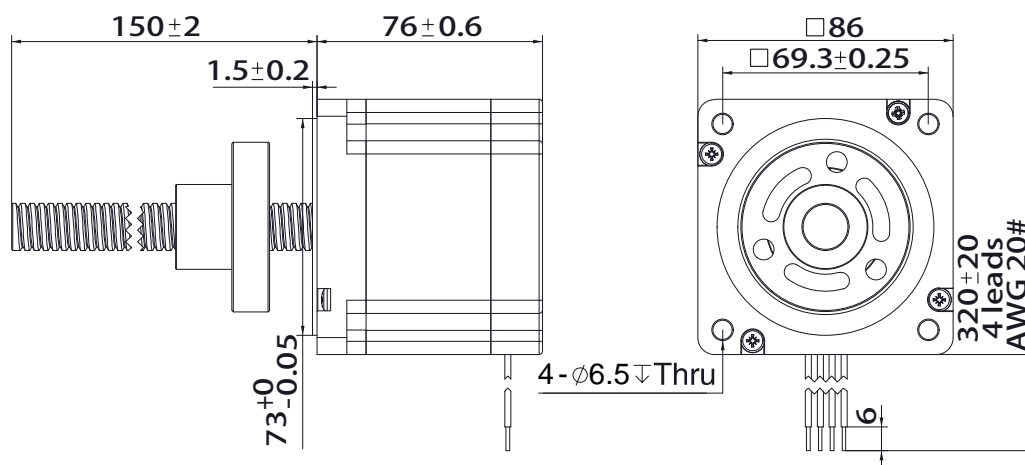

Size 34 (86mm) Series

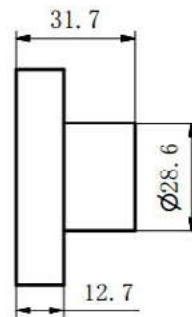
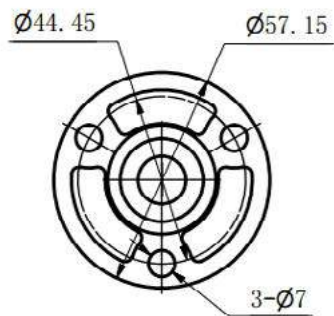

Non-captive

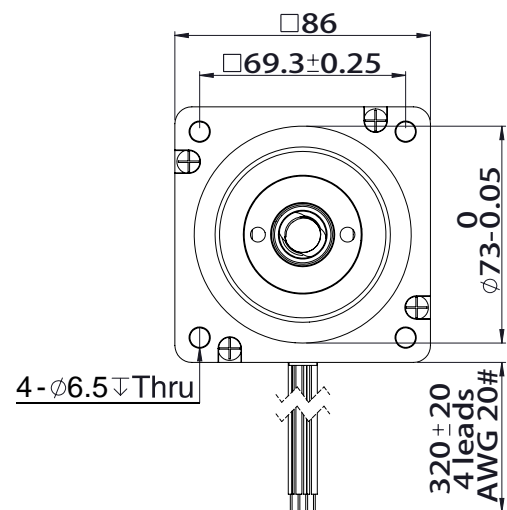
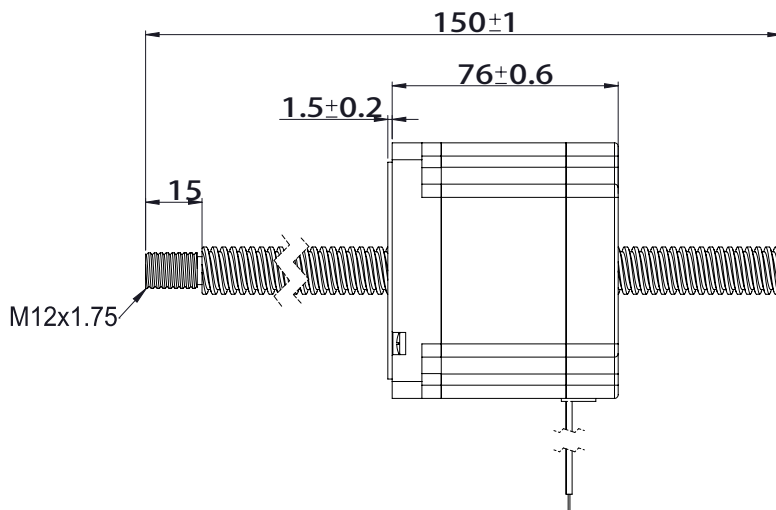

NOTE: All drawings are First Angle Projection – ISO Standard. [3D Models are available].

Size 34 (86mm) Series

Size 34 (86mm) Performance Curves

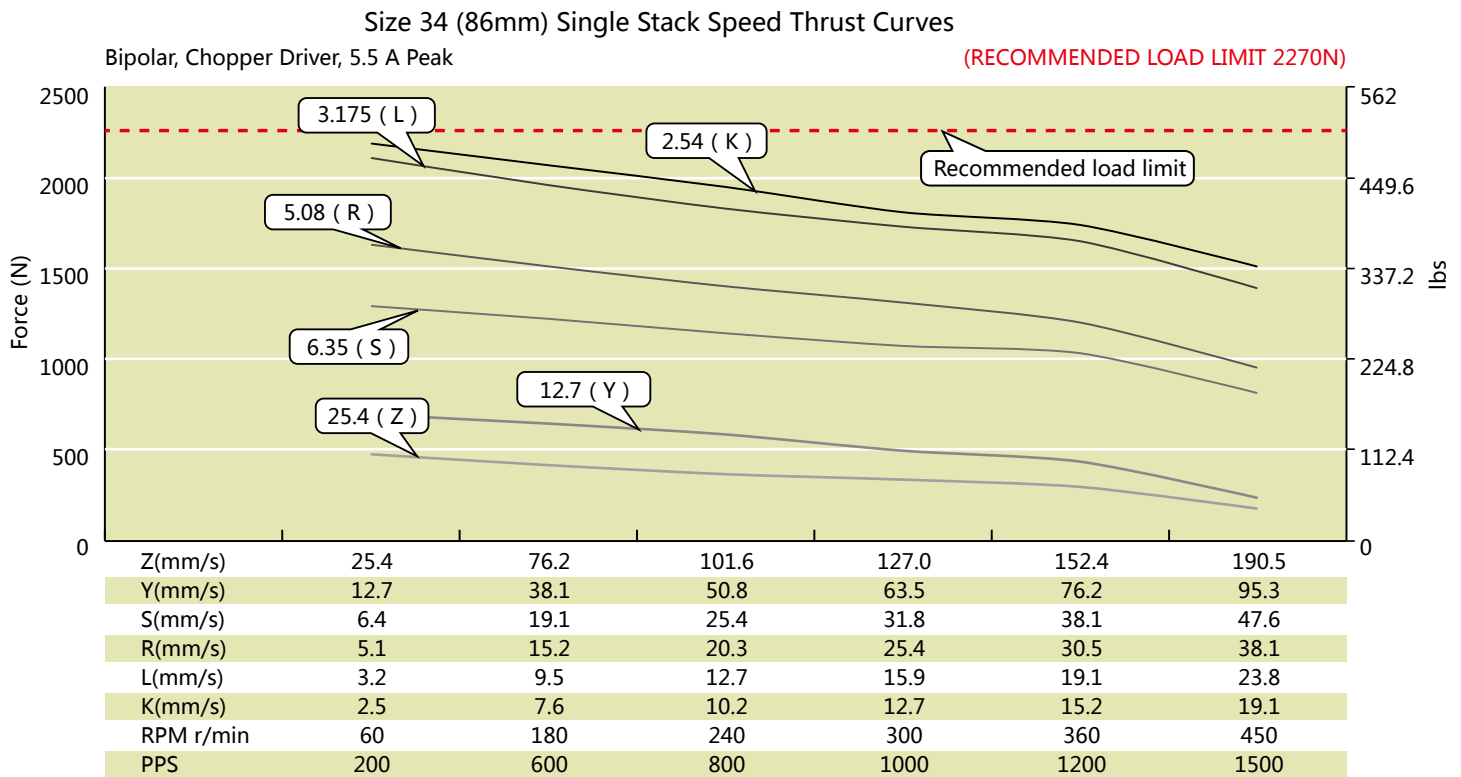

TEST CONDITION:

A-46 Testing Voltage: 40Vdc, Driver Model: DS-2MSD8078-2 bipolar, chopper driver at rated current. Motor's thrust will be changed with different voltage and driver. 50% thrust margin is recommended.